

A top-down view of a white wooden table. In the upper left, a glass of golden beer with a white head of foam. In the upper right, a white bowl containing a light-colored soup or broth with a green herb garnish. In the lower right, a portion of a silver metal tray with a red circular object on it.

# THE WESTIN GRAND VANCOUVER

CATERING INFORMATION 2017

433 Robson Street  
Vancouver, BC V6B 6L9  
Canada

T +1 604.602.1999

F +1 604.647.2535

[sales@westingrandvancouver.com](mailto:sales@westingrandvancouver.com)

[www.westingrandvancouver.com](http://www.westingrandvancouver.com)

# ENDLESS POSSIBILITIES

---

As you begin the planning of your meeting or special occasion, we hope you will consider partnering with us to transform your vision into reality. Your event is as important to us as it is to you. Whether you are hosting 25 friends or 100 conference attendees, our seasoned meeting specialist will assist you with every detail, ensuring your event is a success and that all of your guests leave feeling better than when they arrived.

We know all your meetings are important no matter the size. At the Westin Grand Vancouver, we specialize in smaller, intimate meetings and events, and offer you the undivided attention of our entire team. The hotel offers a total of 6 meeting rooms with over 4,000 square feet of sophisticated function space. All of our meeting rooms and function spaces have windows and are equipped with built-in retractable projection screens and HD wireless projectors.



We are proud to choose 100% green electricity and green natural gas with Bullfrog Power, Canada's leading green energy provider, for all of our meeting rooms and kitchen facilities. This initiative reduces Westin Grand's environmental impact and provides a greener option for your meetings and events. To learn more, visit [bullfrogpower.com](http://bullfrogpower.com).



# MEETING ROOM DESCRIPTIONS

---

## SYMPHONY ROOM – 1307 sq ft

A beautifully appointed meeting room located just off our main lobby. This meeting room features a natural light, 13' ceiling heights and is fully equipped with a built in retractable projection screen and both wireless and ADSL internet capabilities.

## ALLEGRO ROOM – 771 sq ft

The second largest meeting venue located on the lobby level. This meeting room features natural light, 11' ceiling heights and is fully equipped with a built in retractable projection screen and both wireless and ADSL internet capabilities.

## CONCERTO ROOM – 437 sq ft

This meeting room is also located on the lobby level. It features natural light, 10' ceiling heights and is fully equipped with a built in retractable projection screen and both wireless and ADSL internet capabilities.

## RONDO ROOM – 295 sq ft

This meeting room features an existing boardroom with 12 executive chairs. This room also has one large window which allows for natural light. It is ideal for hosting small meetings or as a breakout room.

## HENDRICKS RESTO-LOUNGE – 1259 sq ft

Located off of our main lobby, Hendricks Resto-Lounge is both an old school cocktail bar stirring up decadently crafted cocktails, and a full service restaurant showcasing clean, modern interpretations of contemporary classics.

## PRIVATE DINNING ROOM – 252 sq ft

Enjoy an intimate private dining experience for up to 16 guests for seated meals. The room is bathed in natural light from floor to ceiling windows, and offers state of the art technology including a built in projector and screen for the more formal parts of your dining event

## SONATA ROOM – 564 sq ft

Located on the 3<sup>rd</sup> floor of the hotel, this room features large windows and natural light. It also has doors that open our onto a semi-private terrace.

## OVERTURE ROOM – 493 sq ft

This meeting room is located right across from the Sonata Room. It features floor-to-ceiling windows and door that open onto the terrace.

## GARDEN TERRACE – 1680sq ft

The garden terrace is a hidden oasis adjacent to the pool and overlooking stunning city views and the Vancouver Public Library. This area is ideally suited for outdoor receptions, wedding parties and informal company barbeques (no pool access).

# MEETING ROOM FLOOR PLANS

## Lobby Level

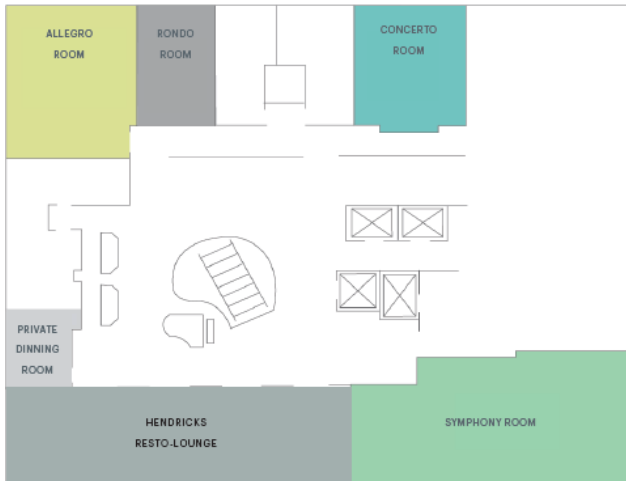

Room Name	Symphony	Allegro	Rondo	Concerto	Hendricks Resto Lounge	Private Dining Room
<b>Area (sq ft)</b>	1307	771	295	437	1259	252
<b>Ceiling Height</b>						
<b>Feet</b>	13'	11'8"	9'8"	8'11"	13'3"	9'7"
<b>Reception</b>	100	65	-	40	-	20
<b>Rounds</b>	70	40	-	30	-	16
<b>Theatre</b>	100	40	-	32	-	-
<b>Classroom</b>	60	36	-	18	-	-
<b>Boardroom</b>	36	28	16	16	-	12
<b>U-Shape</b>	30	25	-	20	-	-
<b>Hollow Square</b>	36	30	-	20	-	-

## Third Level



Room Name	Sonata	Overture	Pool Terrace
<b>Area (sq ft)</b>	564	493	1680
<b>Ceiling Height</b>			
<b>Feet</b>	8'	8'	-
<b>Reception</b>	40	30	100
<b>Rounds</b>	30	30	-
<b>Theatre</b>	36	30	-
<b>Classroom</b>	24	24	-
<b>Boardroom</b>	28	18	-
<b>U-Shape</b>	25	17	-
<b>Hollow Square</b>	28	20	-